

Notes (Unless Otherwise Specified):

1. All dimensions are in inches.
2. Dimensions in [xxx] are in millimeters.
3. Material: 8 MIL Rogers RO4003 Dk = 3.55
4. Line Width = 17.5 MIL.
5. Launch Taper = 13 MIL. X 50 MIL.
6. Max Frequency = 40GHz
7. Hole Diameters are stated as finished hole size.
8. Plated through holes are to have a minimum of .001" copper.
9. No soldermask required.
10. Fabrication Tolerance: End product line widths and lands +/- .0005".
11. Copper Specification Signal Size: 1/2 oz. CU \pm .0002, 1.8 MILS Finished
12. Plating Specification: 3 to 10 microinches Gold over 100 microinches Nickel.

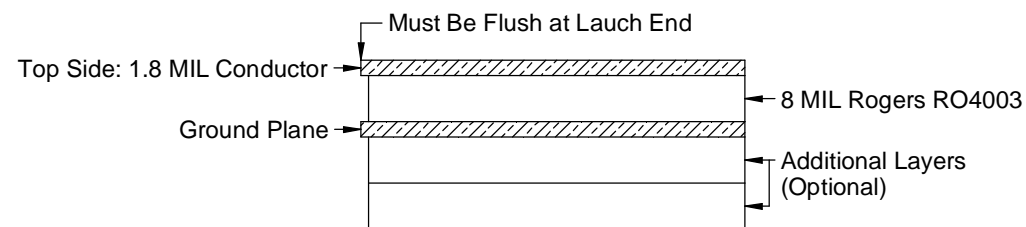

PCB Stackup

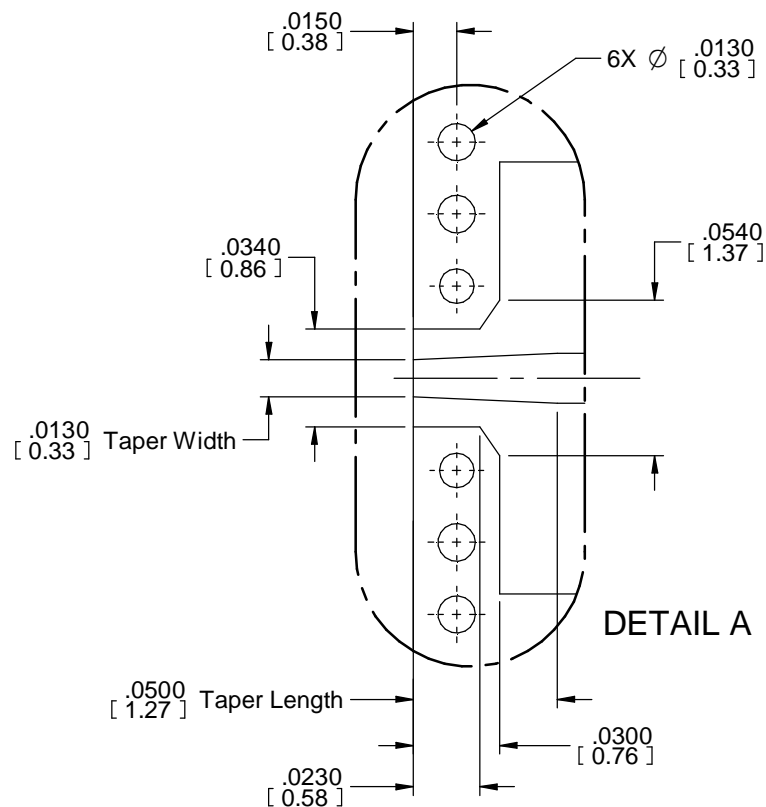
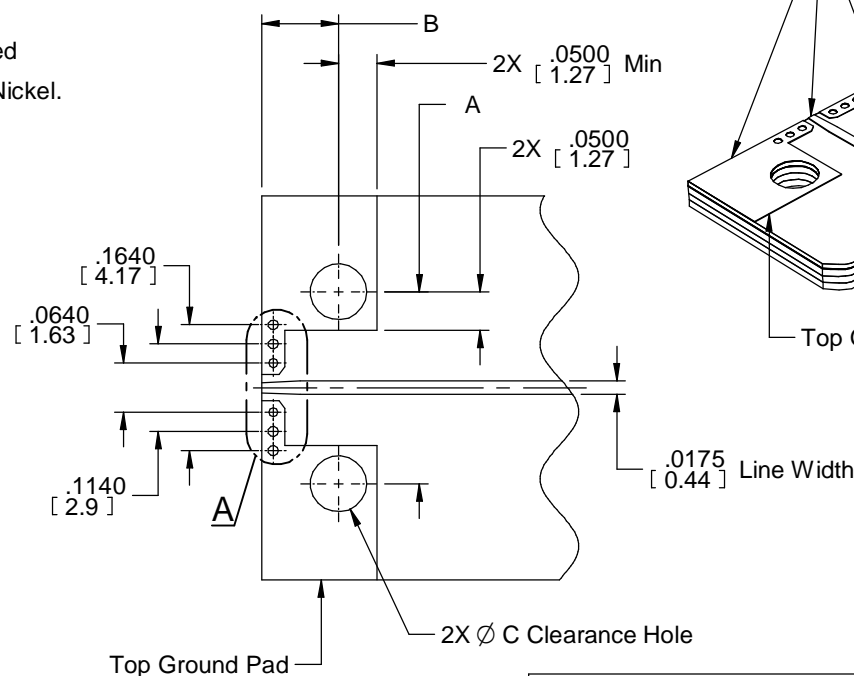
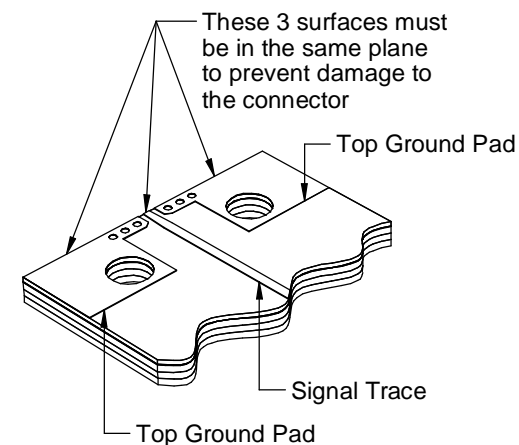

Mounting Holes

Body Width	A	B	Ø C
.370 (Narrow)	.250	.100	.073
.500 (Standard)	.375	.110	.078



SIGNAL
MICROWAVE

MATERIAL

Rogers RO4003
Dk = 3.55

APPROVAL

BR

DATE

06/12/15

014 Launch, Microstrip, 8MIL
Rogers RO4003, 40GHz

DWG NO

EL-MS-M-08-RO4003-014

REV

A

FILE NAME: EL-MS-M-08-RO4003-014, 8mil RO4003 Edge Launch 40GHz.dft

SHEET 1 OF 1