

Notes (Unless Otherwise Specified):

1. All dimensions are in inches.
2. Dimensions in [xxx] are in millimeters.
3. Material: 7.3 MIL Rogers RO4350 Lopro Dk = 3.55
4. Line Width = 15.0 MIL.
5. Launch Taper = 8 MIL. X 40 MIL.
6. Max Frequency = 70GHz
7. Hole Diameters are stated as finished hole size.
8. Plated through holes are to have a minimum of .001" copper.
9. No soldermask.
10. Fabrication Tolerance: End product line widths and lands +/- .0005".
11. Copper Specification Signal Size: 1/2 oz. Cu  $\pm$  .0002, 1.8 MILS Finished
12. Plating Specification: 3 to 10 microinches Gold over 100 microinches Nickel.

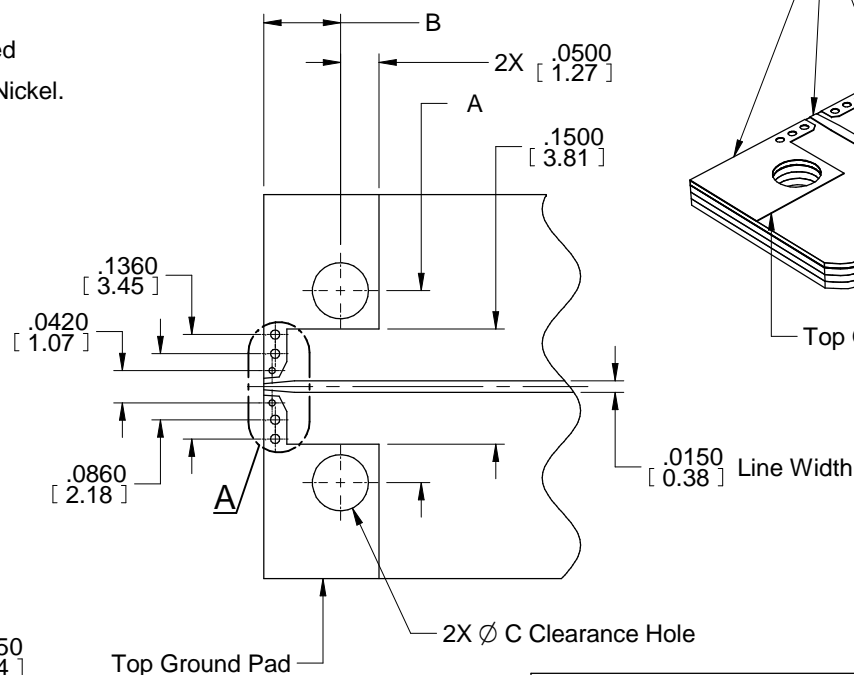

PCB Stackup

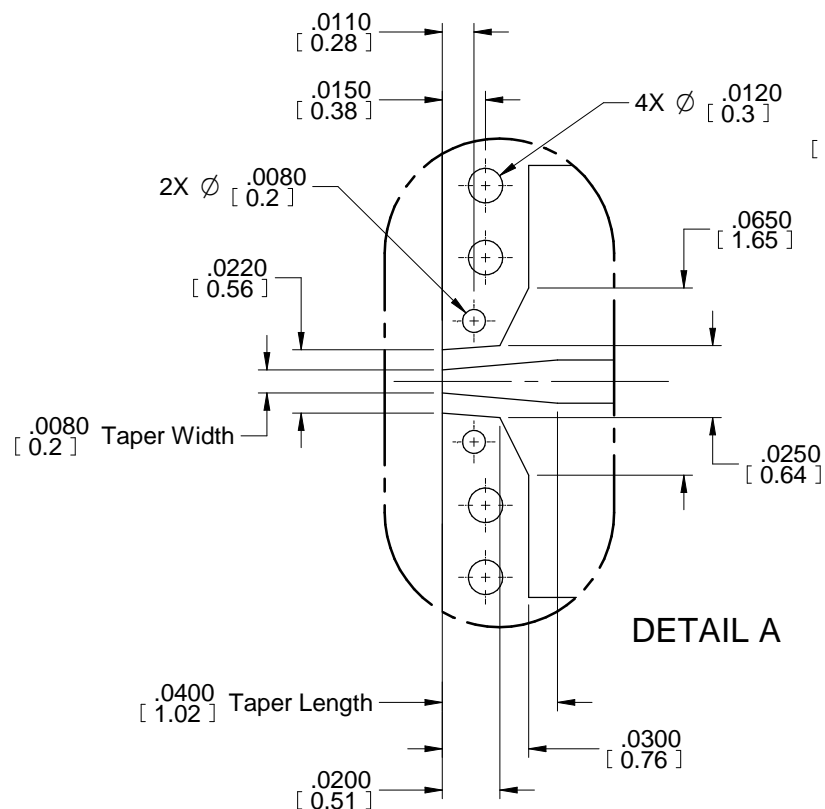
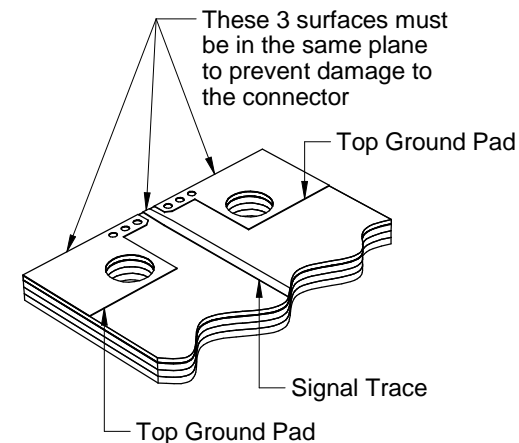

Mounting Holes

Body Width	A	B	Ø C
.370 (Narrow)	.250	.100	.073
.500 (Standard)	.375	.110	.078



**SIGNAL  
MICROWAVE**

MATERIAL

RO4350 Lopro  
Dk = 3.55

APPROVAL

BR

DATE

02/02/16

DWG NO

EL-MS-M-7.3-RO4350 Lopro-039

REV

A

039 Launch, Microstrip, 7.3  
MIL RO4350 Lopro, 70GHz

FILE NAME: EL-MS-M-7.3-RO4350 Lopro-039 RevA.dft

SHEET 1 OF 1